

# Assembly Instructions - Mantis 30

**Note - The counter balance of the arm will not allow the arm to move until the monitor is attached.**

**\*\* You must have the monitor on to make the arm move properly. Do not adjust tension until you have the monitor on the unit first.**

Screen swivel tension adjustment  
3mm Hex key

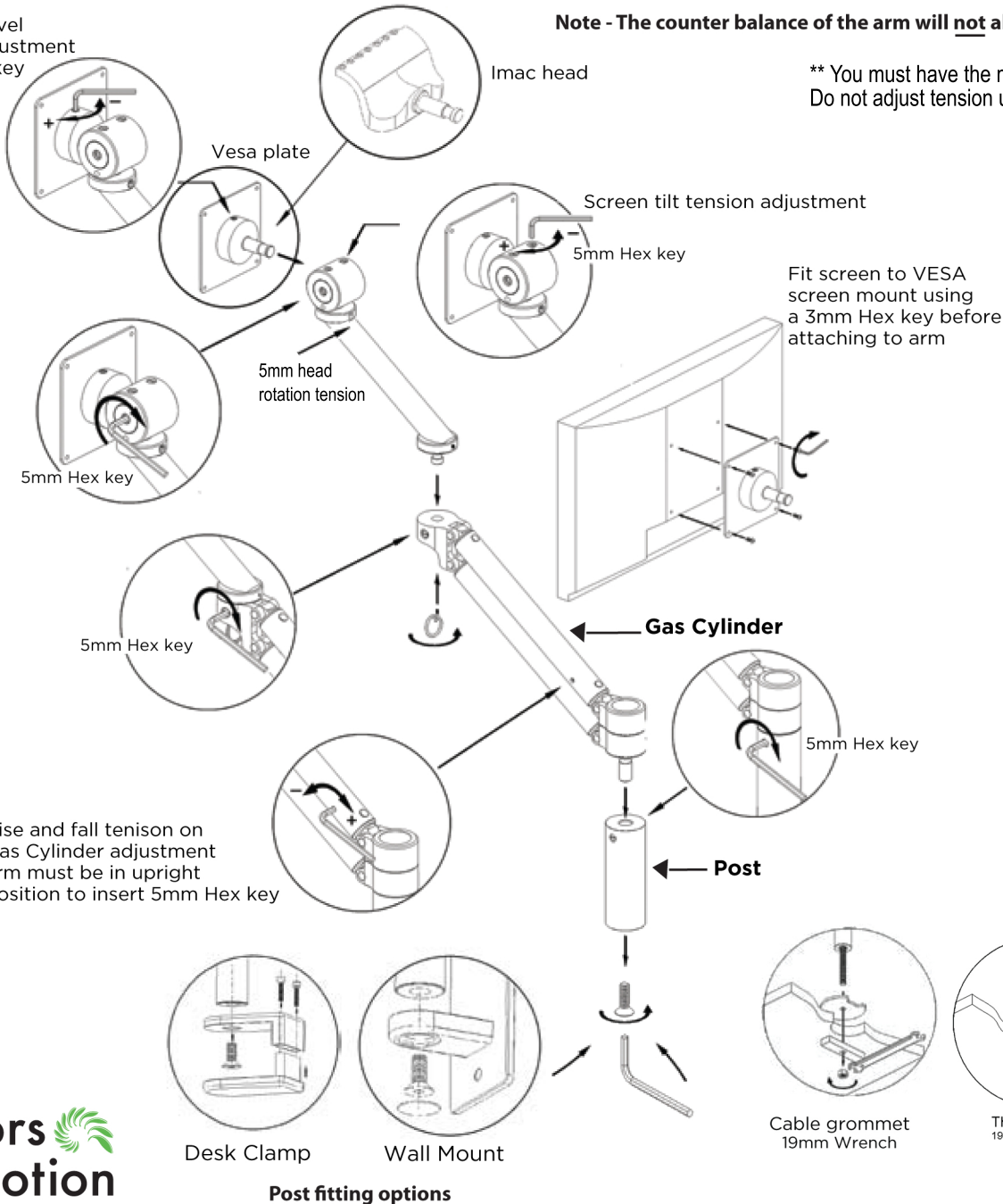

### Instructions:

1. Attach post to mounting option.
2. Use the edge clamp, through desk, cable grommet or wall mount to attach the post to the surface.
2. Insert the gas cylinder into post and tighten using a 5mm hex key.
3. Insert second extension into place and tighten using a 5mm hex key.
4. Attach screen to machedad adapter or VESA plate using a 3mm hex key.
5. Insert Vesa plate or machedad adapter to arm.
6. Adjust screen tilt, screen swivel and rise & fall tension. (Please do not over-tighten)

### Tools Required:

- 8mm Hex key (supplied)
  - 5mm Hex key (supplied)
  - 4mm Hex key (supplied with large edge clamp)
  - 3mm Hex key (supplied)
- 19 mm wrench (customer supplied)

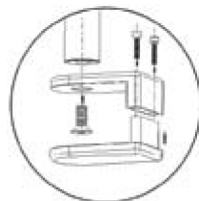

Desk Clamp



Wall Mount

### Post fitting options

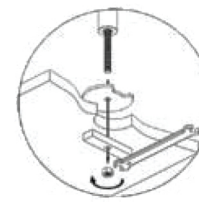

Cable grommet  
19mm Wrench

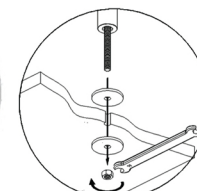

Through desk  
19mm Wrench